

Clear Internal Dimensions - 1070mm x 350mm x 1.300mm

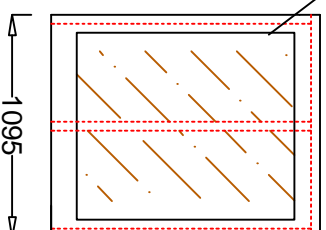

920mm x 1070mm x 18mm Surface Treated Ply Backboard.



- 1No. Double door (900 mm W x 1090mm H Clear Opening)
- 4No. S/St Hinges
- 1No. Yale type Lock
- 2No. Shoot Bolts
- 1No. Compression Seal

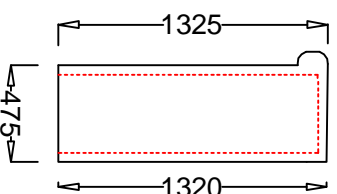
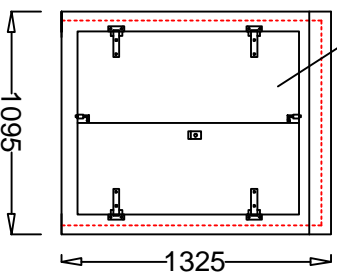
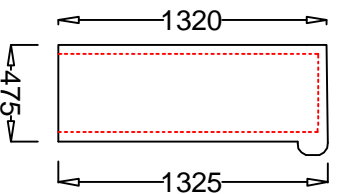

Adept GRP Ltd
 Tel: 01269 843355
 Tel: 01269 832189
 Fax: 01269 844324
 Unit 4, Heathfield Industrial Estate,
 Thornhill Rd, Cwmgwilli, Crosshands
 SA14 6PT

Company: ADEPT GRP Ltd		Drawn: Dan Phillips		External Colour - BS or RAL	
Contact: Vernon Phillips		Date: 13.06.13		Construction: Single Skin const.	
Scheme Title: VR6		Checked:		Drawing No. VR6	
				Job No. VR6	
				Rev:	