

760mm x 1020mm x 18mm Surface Treated Ply Backboard.

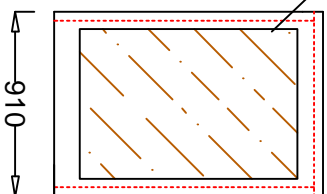

Clear Internal Dimensions - 900mm x 360mm x 1200mm

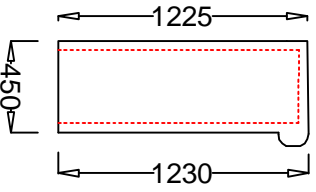

- 1No. Double door (760 mm W x 1050mm H Clear Opening)
- 4No. S/St Hinges
- 1No. Yale type Lock
- 2No. Shoot Bolts
- 1No. Compression Seal

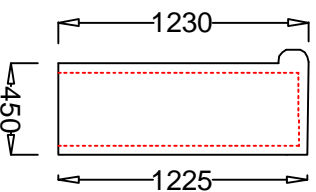
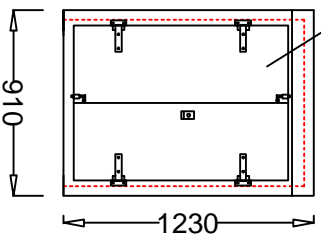

Adept GRP Ltd
 Tel: 01269 843355
 Tel: 01269 832189
 Fax: 01269 844324
 Unit 4, Heathfield Industrial Estate,
 Thornhill Rd, Cwmgwilli, Crosshands
 SA14 6PT

Company: ADEPT GRP Ltd		Drawn: Dan Phillips		External Colour - BS or RAL	
Contact: Vernon Phillips		Date: 13.06.13		Construction: Single Skin const.	
Scheme Title: VR5		Checked:		Drawing No. VR5	
				Job No. VR5	
				Rev:	